



New Tech Machinery

The World's Finest Portable Rollforming Equipment



MACH II™

Gutter Machines

5", 6", 5-6 Combo

www.NewTechMachinery.com

MACH II™ Gutter Machines

The "ORIGINAL" polyurethane drive system. VERSATILE...INNOVATIVE...DEPENDABLE...PROFITABLE

New Tech Machinery's patented MACH II gutter machines have changed the gutter industry forever.

Don't get stuck with an imitation, DEMAND THE ORIGINAL!

STANDARD FEATURES (with loaded machines)	
• Polyurethane Drive rollers	• Two 360° Rotatable Reel Stands with Easy Lift Reels
• Stainless Steel Forming Rollers	• Electric Motor 3/4Hp, 110VAC, 60Hz, 1Ph, 11 AMPS
• Push Button RUN/JOG controls at Entry and Exit Ends	• Welded Tubular Steel Frame
• Forward Pulling, Easy Cut Shear	• Industry's Best Warranty
• Power Interruption Safety Circuit	

OPTIONS	
ROS1; ROS3 – Run Out Stand ; Set of 3 Run Out Stands	ELEC2 – 3/4 Hp, 110VAC, 50 Hz, 1Ph, 11Amps
RL15 – 15" Reel (380mm)	ELEC3 – 3/4 Hp, 220VAC, 50Hz, 1Ph, 5Amps
RL20 – 20" Reel (500mm)	12 VOLT – 1Hp, 12VDC, 80Amps (Battery not included)
TRN – Turnstile Reel Stand	BB5 – Bottom Bead Assembly, 5"
RAC – Transfer Bars	BB6 – Bottom Bead Assembly, 6"
CR 5/6 – 5" Cradle and/or 6" Cradle	BF5 – 1" Back Flange for 5"
REM-2 – 2-Button Remote Control	BF5SH – 1" Back Flange Shear for 5"
GFI – Ground Fault Interruption Plug	BF15-5 – 1-1/2" Back Flange for 5"
HK5/ HK6 – Alcoa Hook Assembly, 5" or 6"	BF15-5SH – 1-1/2" Back Flange Shear for 5"
HK56 – Alcoa Hook Assembly, 5"/6" Combo	BF6 – 1" Back Flange for 6"
RISER 6-8; RISER 10-12 – Riser Pad 6"-8"; Riser Pad 10"-12"	BF6SH – 1" Back Flange Shear for 6"
CVR-GM5/6/56 – Machine Covers	BF15-6 – 1-1/2" Back Flange for 6"
EZC-G – EZ-Counter Computerized Length Controller	BF15-6SH – 1-1/2" Back Flange Shear for 6"

SPECIFICATIONS	
5" Gutter Machine <ul style="list-style-type: none"> Length 8' (2.4m) Width 2' (.6m) plus shear handle Height 3'10" (1.2m) Weight 1000 lbs (454kg) 	MATERIALS FORMED <ul style="list-style-type: none"> Painted Steel 30 ga. to 24 ga. (.3mm to .6mm) Painted Aluminum .019" to .032" (.5mm to .8mm) Copper 16 oz. to 20 oz. 3/4 Hard (.5mm to .7mm)
6" Gutter Machine <ul style="list-style-type: none"> Length 10' (3.0m) Width 2' (.6m) plus shear handle Height 3'10" (1.2m) Weight 1250 lbs (570kg) 	SHEAR Manually Powered, Hardened Tool Steel Blade and Dies
5" - 6" Combo Gutter Machine <ul style="list-style-type: none"> Length 10' (3.0m) Width 2' (.6m) plus shear handle Height 3'10" (1.2m) Weight 1350 lbs (610kg) 	MATERIAL WIDTH <ul style="list-style-type: none"> 5" Machine: 11-3/4" to 12-3/8" (300mm to 315mm) 6" Machine: 15" (380mm)
SPEED <ul style="list-style-type: none"> 50 ft./min (15m/min) Approx. 	DRIVE <ul style="list-style-type: none"> Electrically Driven Polyurethane Rollers

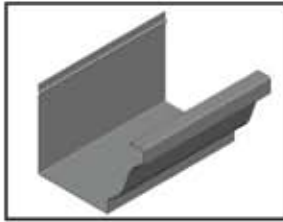

Straight Back Gutter

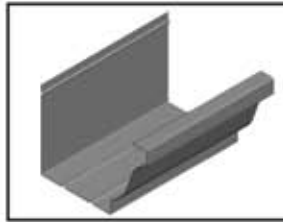

Gutter w/ Bottom Bead

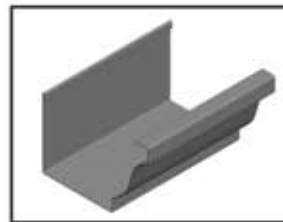

Gutter w/ Alcoa Hook

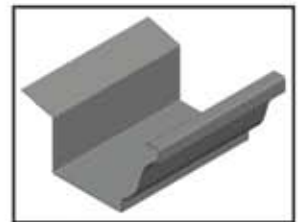

Gutter w/ Back Flange

Options



Shear



Coil Cradle



2 Button Remote Control (start, stop)



Push Button Controls



Turnstile Reel Stand



EZ-Counter Computerized Length Controller

Warranty

- Three years parts / Three years labor (including electrical)
- Limited lifetime against separation on drive rollers
- Limited lifetime on stainless steel forming rollers

U.S. PATENT NO. 5,394,722
U.S. PATENT NO. 5,740,687